



**EARTH TECH**

Mfg.: Industrial Valve



Industrial Valve



Ball Valve



Tube Fittings



# Industrial Valve



**Quality**  
of your Job!

EARTH TECH Industrial Valves are designed and manufactured in compliance with API, ANSI, BS and other recognized standards. EARTH TECH not only restricts its valves to the above standards but adheres to maintain the quality from procurement of raw material to the finished product. EARTH TECH manufactured complete range of Industrial Valves Gate, Globe, Check, Ball Butterfly & Plugs from 1/4" to 18" sizes varying from 150 to 2500 class in Forged / Cast Carbon & Stainless Steel.

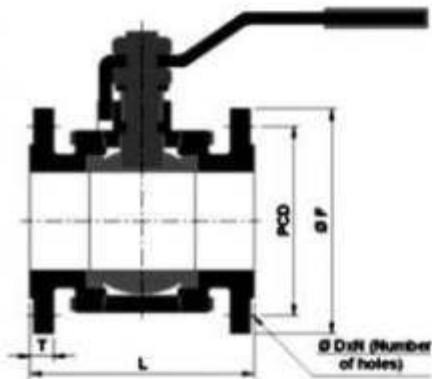

Dimension in mm

Size	150#					300#				
	L	F	T	PCD	DxN	L	F	T	PCD	DXN
25	127	108	11.1	79	16x4	176	124	17.5	89	19x4
40	165	127	14.3	98	16x4	191	156	20.6	114	22x4
50	178	152	15.9	121	19x4	216	165	22.2	127	19x8
65	191	178	17.5	140	19x4	241	190	25.4	149	22x8
80	203	191	19.1	152	19x4	283	210	28.6	168	22x8
100	229	229	23.8	191	19x8	305	254	31.8	200	22x8
125	255	254	23.8	216	22x8	381	280	34.9	235	22x8
150	267	279	25.4	241	22x8	403	318	36.5	270	22x12
200	292	343	28.6	298	22x8	419	381	41.3	330	25x12
250	330	406	30.2	362	25x12	457	445	47.6	387	29x16
300	356	483	31.8	432	25x12	502	521	50.8	451	32x16

Test Pressure	150#	300#	Socket Weld/ Screwed Ends
Body [ Hydro ]	32 kg/cm <sup>2</sup>	83 kg/cm <sup>2</sup>	104 kg/cm <sup>2</sup>
Seat [ Hydro ]	21 kg/cm <sup>2</sup>	53 kg/cm <sup>2</sup>	—
Seat [ Air ]	06 kg/cm <sup>2</sup>	06 kg/cm <sup>2</sup>	06 kg/cm <sup>2</sup>

### Ball Valve - Technical Specification

Size Range	15 NB through 300 NB
Pressure Rating	ANSI/BS 150#, 300#, 600#
Type	3 piece/2 Piece/ 1Piece/ Fire Safe/ Non Fire Safe
End Connection	Flanged/ Screwed/ Socket Weld
Operation	Wrench/ Manual/ Gear/ Pneumatic
Port Opening	Full/ Regular
Seat	PTFE/ Carbon or Glass Filled Teflon/ Graphite
Wedge/Disc/Ball	Floating/ Trunnion mounted
Gasket & Packing	PTFE/ Glass Filled Teflon/ Graphite
MOC	Refer Material Chart
Design Code	BS - 5351
Testing	API 598
Inspection	3rd Party/ Client/ Manufacturer

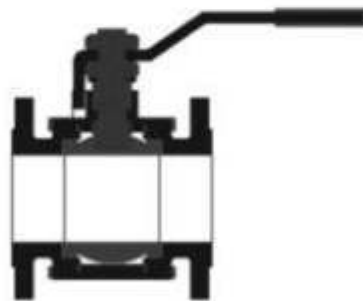

**EARTH TECH**



2-way on off 3, 4 or 5 way Switching Models. Heavy directional black fenolic handle or lever handle. Blow-out proof bottom loaded stem. Low operating torque and with panel mounting facilities. Series of end connections 1/4" to 1" NPT and BSP. Male or female threaded ends EARTH TECH single or twin ferrule tube fitting ends. Floating Ball design for positive sealing. Maximum working pressure upto 10000 PSI.

## Ball Valve

Size	Dimension in mm				
	A	B	C	D	E
8	67	45	120	14.61	10
10	67	45	120	18.03	10
15	67	45	120	22.23	10
20	73	50	120	27.56	13
25	95	60	150	34.29	13
32	116	76	180	43.10	13
40	116	76	180	49.15	13
50	127	85	180	61.62	16

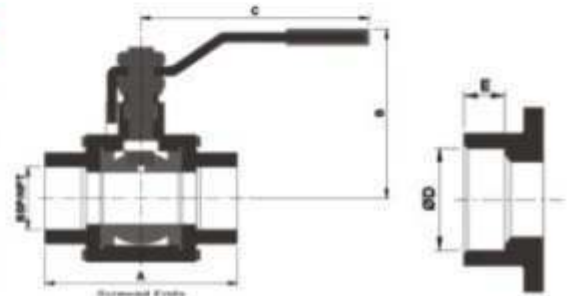

### Material of Construction

Name of Parts	Carbon Steel	Stainless Steel
Body & Connectors	A-105 or A216 Gr. WCB	A351 Gr. CF8 or CF8M
Ball	ASTM A-351 Gr. CF8	A351 Gr. CF8 or CF8M
Stem	AISI-304	AISI-304 or AISI-316
Seats	Virgin/Glass Filled Carbon Filled PTFE	Virgin/Glass Filled Carbon Filled PTFE
Seals	Glass Filled PTFE	Glass Filled PTFE

EARTH TECH Instrumentation Tube fittings provides a zero leak proof seal which will withstand high pressure, impulse, vacuum, vibration and temperature. These feature offers highest safety and maintenance free smooth working guarantee. Each component on every EARTH TECH tube fitting is precision machined to the most exacting dimensional tolerance, maintaining TQM practices throughout manufacturing process, thus confirms to ISO Quality Standard requirement or our valued customers throughout the world.



## Tube Fittings



**EARTH TECH**

## COMPANY PROFILE :

We are Manufacturers of EARTH TECH brand valves in the small sector. We Manufacture Quality Valves of almost all types for a wide spectrum of users in the Process & Chemical, Refineries & Petrochemicals, Fertilizers, Drugs & Pharmaceuticals, Thermal Power Stations, Nuclear & Atomic Power Stations, Textiles, Dyes & Intermediates, Paints & Varnishes, Sugar, Breweries & Distilleries, Soaps & Detergents, Steel Plants, Food & Oil Industry, Solvent Extraction Plants, Sewage, Effluent & Water Treatment, Cooling Water, Ship Yards and Marine Management, Water Works, Pulp & Paper, LPG Bottling Plants, Onshore & Offshore platforms, Slurry & Ash handling.

Our Unit is managed by a team of qualified personnel with extensive experience in the field. From a modest beginning in 1986, we have since made rapid strides in technology and statute and are today recognized by our esteemed customers as the most reliable single point source for their versatile requirement of Valves. Their sustained support bears ample testimony for the confidence reposed in us.

Whether it be a well planned project installation or contingent maintenance replacement, we at EARTH TECH gear ourselves up to our customers exacting requirements and supply well within time as Marginal stocks of standard sizes and ranges of valves are available with us.

We use Quality Raw Materials (Castings & Forgings ) from reputed foundries/forging shops and we have Statistical Quality Assurance system with inspection at every stage of Manufacture to ensure sustained quality in our supplies. We have adequate capacity in terms of expertise and finance are in a position to undertake large volume of orders with committed deliveries.

At EARTH TECH, you do not have to pay a premium for Quality.

**When Customer demanded his own designed Material, Drawing or Sample required and its design development charge will be extra.**

**Sample development period 15 days production will be started after approval of sample.**



## EARTH TECH

Gondal Road, 150 Feet Ring Road,  
Near Jackgon Co., Vavdi,  
Dist. Rajkot-360 004. (Guj.) INDIA.  
Ph.: +91-281-231 14 06  
Cell : +91-92276 32734, 94290 97658, 92276 32733  
e. : info@earthtech.co.in  
w. : www.earthtech.co.in